



MINISTRY OF HOUSING, COMMUNITIES &  
LOCAL GOVERNMENT

# COMMUNITY VISION STATEMENTS

13 FEBRUARY 2019, BIRMINGHAM.



**BETTER DESIGN FOR BETTER PLACES**

# CONTEXT



On the eve of the national MHCLG Conference on Better Design for Better Places, 40 people from diverse households attended the Community Vision event in Birmingham. The 40 guests represented the demographic shifts that are happening in our towns and cities including ethnically diverse, young people and people over 65.

We started with 3 statements, 3 questions and 3 aims for the workshop.

1. Demand for housing has never been higher...  
Do we want to build housing estates or neighbourhoods?  
The aim is to design the Liveable neighbourhood.

2. Loneliness and isolation is impacting our lives...  
Can we design places that help us stay connected with other people?  
The aim is to design the Liveable Street.

3. Society is changing: we are living longer, we are more diverse, we are living longer alone and having families later in life....  
What choice of housing will meet our changing needs over our lifetime?  
The aim is to design the Adaptable Home.

Four core themes emerged from the event supported by more detailed guidance.



# 1 BUILD COMMUNITIES

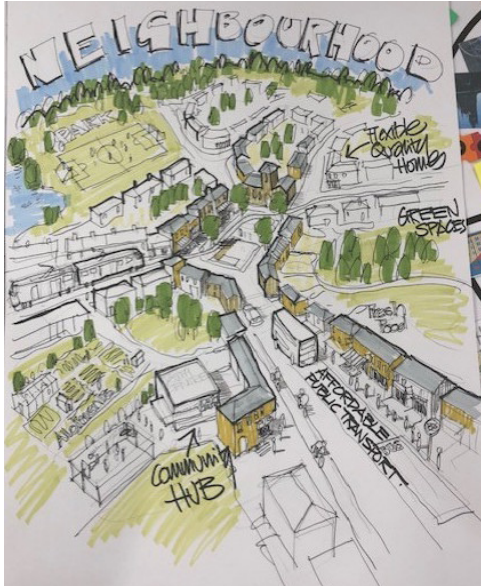

Community Hubs to bring shared indoor/outdoor flexible communal facilities together for intensity and interaction e.g. a school/library/playing field/multi-functional places of worship/places to share food, and other meeting places.

Using the same spaces for different activities; open all hours, multi-use, intergenerational, free/low cost, and at the neighbourhood and street scale.

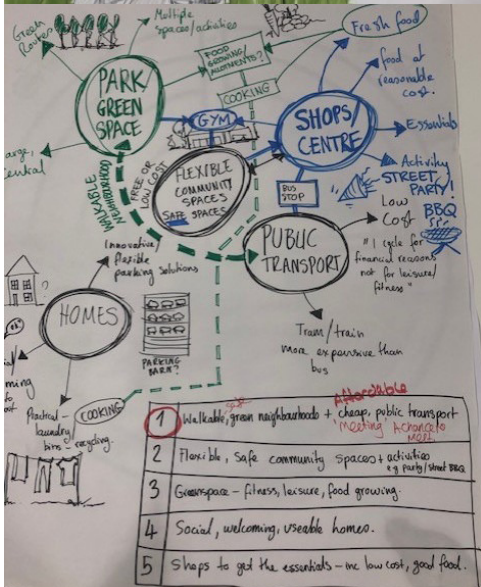

# NEIGHBOURHOOD





# STREET



# 2 BUILD NEIGHBOURHOODS

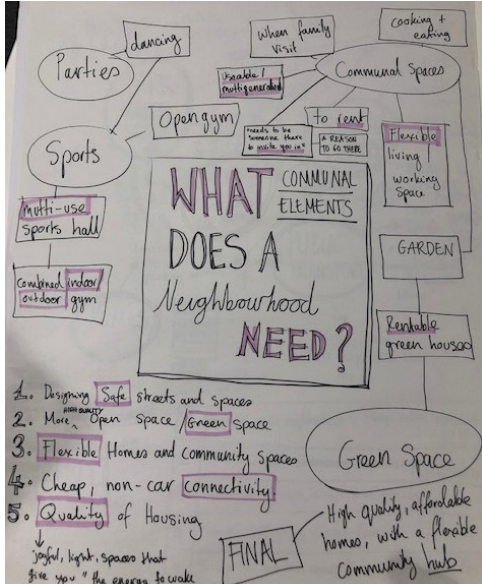

A 'village-feel' or neighbourhood – not a housing estate.

A 5-min neighbourhood that is convivial, friendly, safe and liveable where facilities that are convenient in what they offer are close by, accessible and pleasant to get to on foot, by bicycle and on public transport. A High Street.

Low rise (less than 10 stories), high density neighbourhoods with variety of green spaces nearby – community gardening, play areas, BBQ areas, outdoor games and sports, open gyms, orchards, parks, and landscaping.

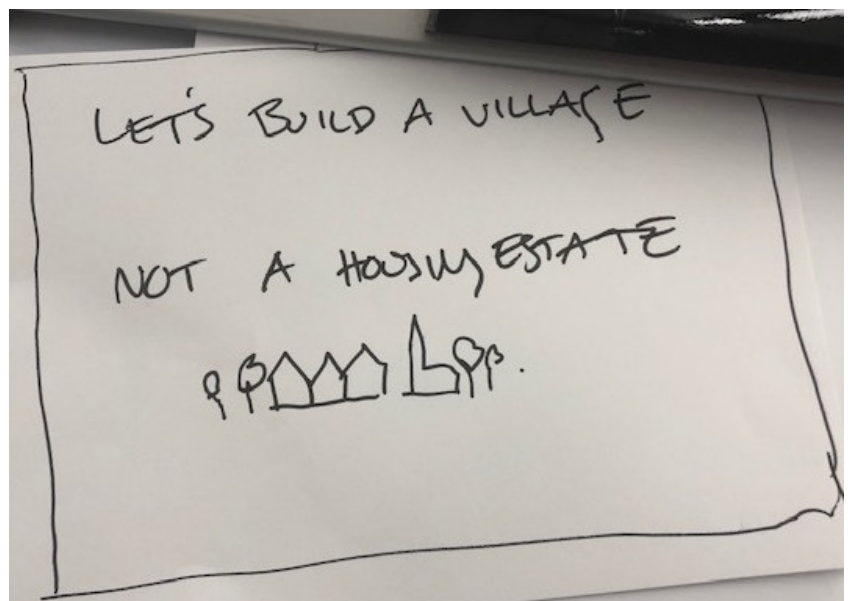
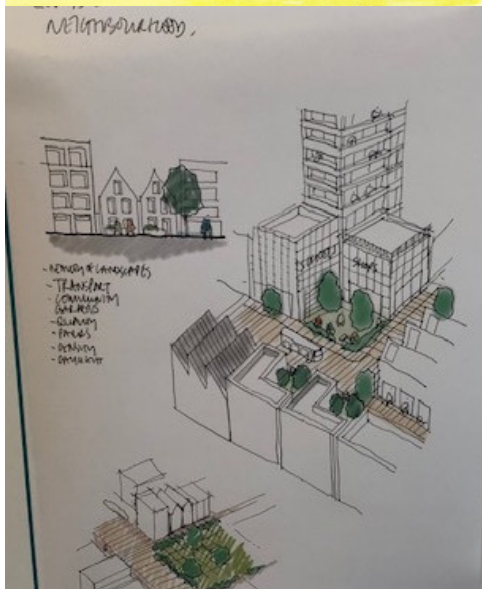

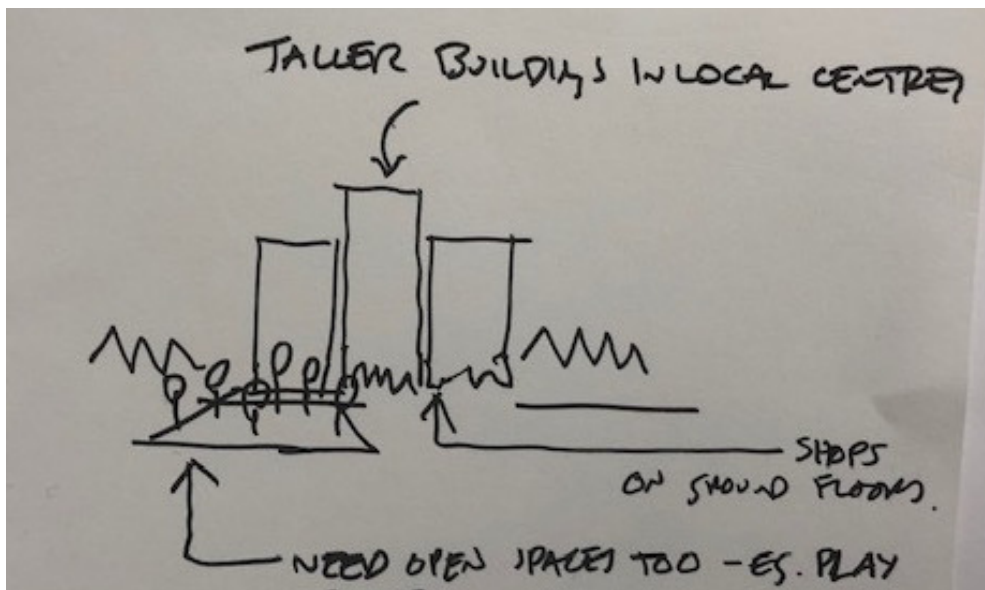



# 3 BUILD QUALITY HOMES TO LAST

Well designed high quality homes to last – joyful, bright, spacious, soundproof, generous in-built storage, energy/waste efficient and recycling waste, small footprints, beautiful, and connected to the neighbourhood.

Future-proofed for accessibility, flexible interior with sub-dividable rooms, integrated yet independent habitable units for the elderly and young people living at home longer.

Diversity – every site and every location is different and requires different responses.

Invest in the fabric of the building.

Talk and listen to the younger generation and involve them in self-build.



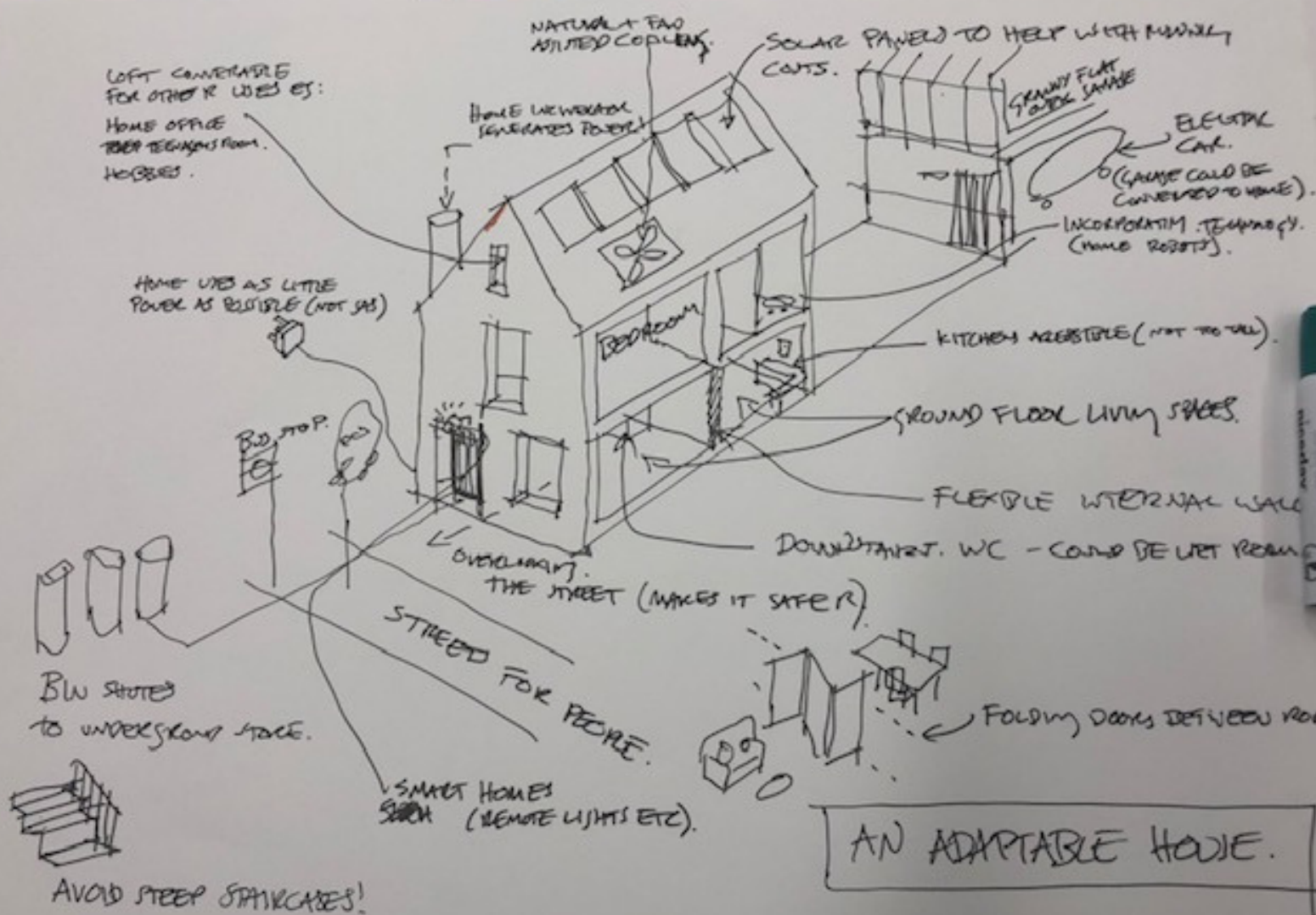



# 4 BUILD CONNECTIONS BETWEEN PLACES



Integrated transport - accessible, well-designed for walking/cycling/trams/trains/buses, affordable, and safe streets.





# CONTRIBUTORS



Funded by:

Ministry of Housing, Communities and Local Government

Delivered by:

MELA Social Enterprise

[www.melasocialenterprise.com](http://www.melasocialenterprise.com)

Facilitators:

Paul Chapman, MELA Social Enterprise

Hannah Barter, Urban Vision CIC

Angela Koch, Imagine Places

Leo Hammond, Lambert Smith Hampton

Yasmin Shariff, Dennis Sharp Architects

Urbanists/Architects

David Rudlin, Urbed

Robert Sakula, Ash Sakula

Alexis Butterfield, Pollard Thomas Edwards

Matthew Westley, Glenn Howells Architect

Joel Kempsey-Fagg, D5 Architects

